

SideWynder™

Giving heavy panels
the light touch

Ideal for panels of up to 880lbs

TESTED TO
10,000
CYCLES

**COMING
SOON**

Face adjustable making installation
and on-site servicing easy.

Dual layer bogie carriage design
ensures smoother panel operation.



**ANTHONY
INNOVATIONS**
Moving Doors And Windows Forward

To discuss your requirements contact us on:
E: salesna@anthonygroup.net

The slimline solution for big panels

Features and Benefits:

- 440lbs load capacity enables you to build doors of up to 880lbs
- Face adjustable, making installation and on-site servicing easy (not adjustable under load).
- Made with pressed metal components and forged axels to ensure robust product under large weights.
- Polymer wheels reduce noise and minimise track wear, guaranteeing system performance over time.
- Precision bearing components reduce operating force.
- Dual layer bogie system ensures balanced load distribution which guarantees smooth system operation.
- Retains structural integrity during and after installation which ensures product durability and longevity.

Reduced Rolling Resistance:

The 7000Quad Series is designed for durability and performance and provides effortless panel operation over time.

Standard models available with:

- **Stainless steel** or **polymer** CNC engineered wheels
- 1.25" and 1.50" wheel diameter
- 0.30" adjustment range

Other mounting tab variants, wheel sizes and spacer attachments available upon request.

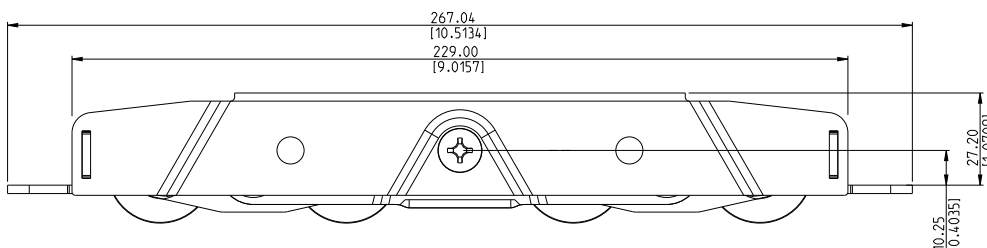

FULLY RETRACTED

[1.25" wheel version shown]

